

S. R. 706 INDIANTOWN ROAD

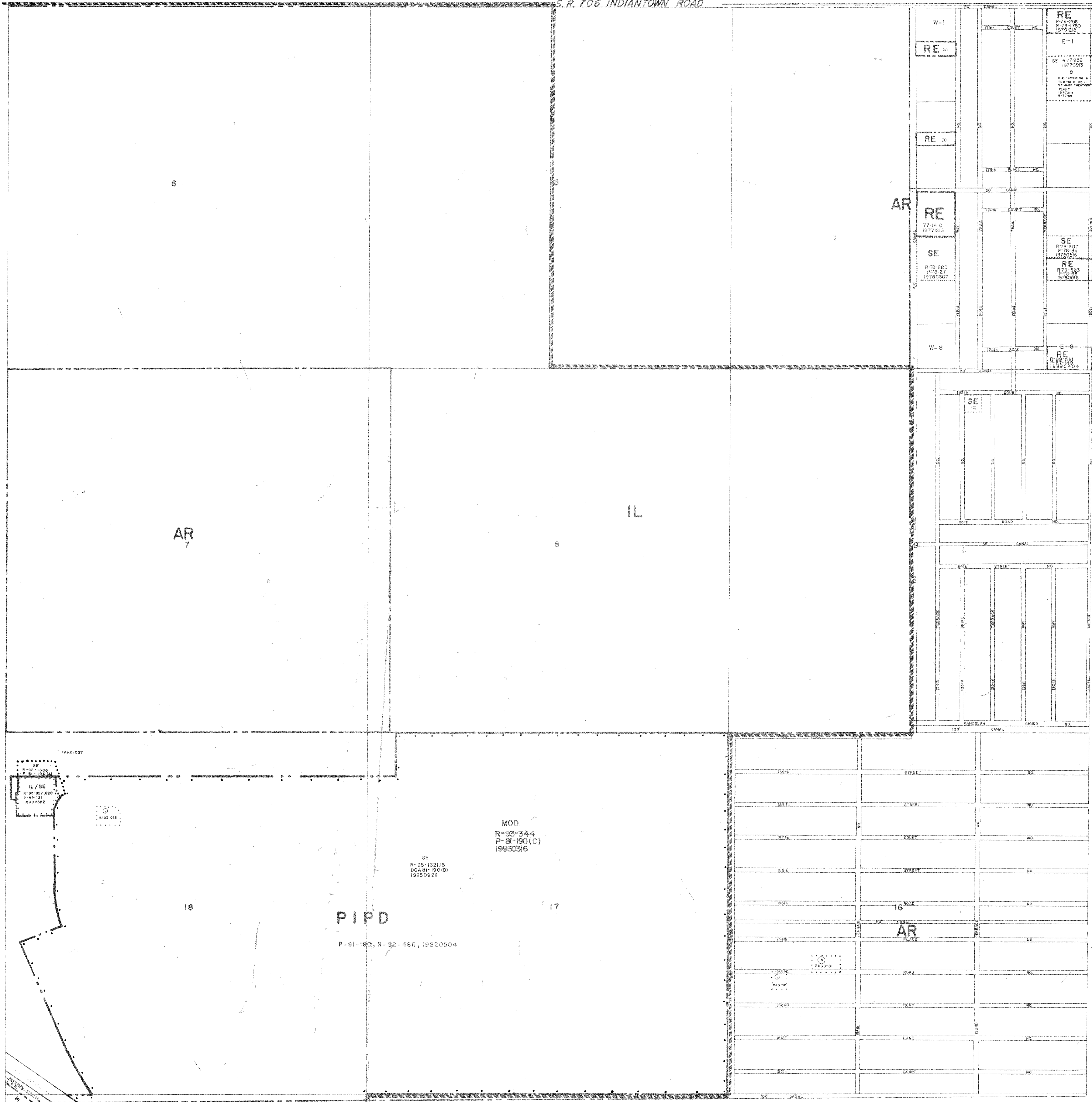

IL/SE
R-95-1321.15
004.81' (90'D)
1995.09.28

MOD
R-93-344
P-81-150(C)
1993.03.16

PIP
P-81-180, R-82-468, 1982.05.04

The zoning category for the property indicated on this sheet may not be consistent with the property's Future Land Use designation under the Palm Beach County Comprehensive Plan. Please contact the Palm Beach County Planning Division at 100 Australian Avenue, West Palm Beach, FL 33406, (561) 233-5300, to confirm the property's Future Land Use designation and other relevant Comprehensive Plan requirements.

PALM BEACH COUNTY, FLORIDA
OFFICIAL ZONING DISTRICT MAP
 Scale 1" = 600' approx. Date 4-1-73
 Quadrant 41-41 B Sheet No. 71

RESOLUTIONS	
01	01-27-210
02	01-28-210
03	01-29-210
04	01-30-210
05	01-31-210
06	01-32-210
07	01-33-210
08	01-34-210
09	01-35-210
10	01-36-210
11	01-37-210
12	01-38-210
13	01-39-210
14	01-40-210
15	01-41-210
16	01-42-210
17	01-43-210
18	01-44-210
19	01-45-210
20	01-46-210
21	01-47-210
22	01-48-210
23	01-49-210
24	01-50-210

RT-0
 DISTRICT BOUNDARIES
 CORPORATE BOUNDARIES

B	A
C	D